

- 4.1. Thatching;
- 4.2.2. Roof batten (d= 70 mm);
- 4.3. Lath of film 34 x 45 mm;
- 4.4. Film;
- 4.5. Distance lath 34 x 45;
- 4.6.2. Fire barrier;
- 4.9.1. Rafter 45 x 195 mm;
- 4.10. Insulation 200 mm;
- 4.11. Moisture/air barrier;
- 4.12.1. Ceiling panelling 15 x 120 mm;
- 4.13. Ceiling skirting 19 x 40 mm

- 4.1. Thatching (300 mm);
- 4.2.2. Roof batten (d= 70 mm);
- 4.3. Lath of film 34 x 45 mm;
- 4.5. Distance lath 34 x 45;
- 4.6.2. Fire barrier;
- 4.9.1. Rafter 45 x 195 mm;
- 4.14. Gable and eaves boarding 18 x 142 mm

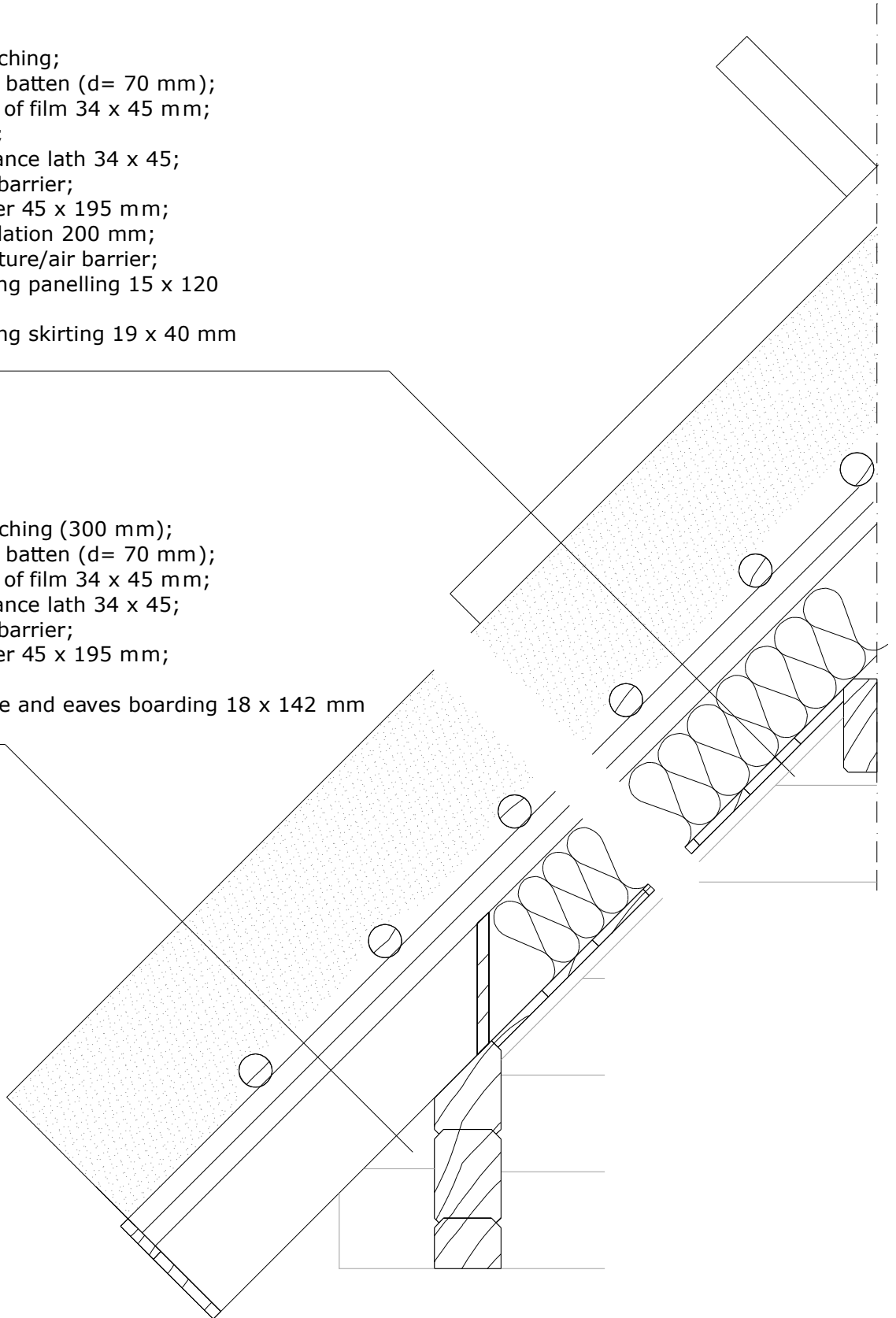

In case of this rooftype the minimum roof angle is 45 degrees

Thatched roof	
Position:	4